

### Electronic Brake Controller

- 100% electronic. Solid-state advanced design gives maximum reliability.
- Built-in automatic current limiter protects controller from trailer brake wiring shorts.
- Red LED indicator light monitors performance and proper controller response. NO HYDRAULIC CONNECTION or foot pedal adapters.
- Built-in load control. Allows trailer braking adjustment by dialing the control knob inside the towing vehicle.
- Easy installation. Simple 4-wire hook-up required.
- Designed for 2- and 4-wheel trailer brake systems.
- Automatic and manual operation.
- Compact and lightweight.
- One-year warranty.

3-1/4" W x 6-1/2" L x 1-1/4" H

81741-B  
\$144.69

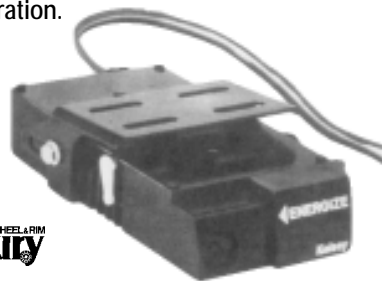

### Push-to-Test Breakaway Kit

- Activates electric trailer brakes in the event of a breakaway
- LED lights indicate a good charge, battery charging or low battery
- Cable lanyard connects tow vehicle to trailer breakaway battery
- Push-to-test battery case protects battery from the elements
- Bolt-on mounting system for secure installation on the trailer
- Meets DOT requirements for holding / breakaway situations
- Compatible with trailers with up to three axles
- Required in most states



52044  
\$59.95



### Electric Brakes

Determine the size of your brake by measuring the diameter of the mounted brake shoe. Next measure the width of the lining.

NOTE: When determining the left or right side brake assembly, always position the brake so that the magnet is at the BOTTOM. For electric brakes, the actuating arm always curves from the pivot pin to the magnet - toward the right on right-hand brakes and toward the left for left-hand brakes.

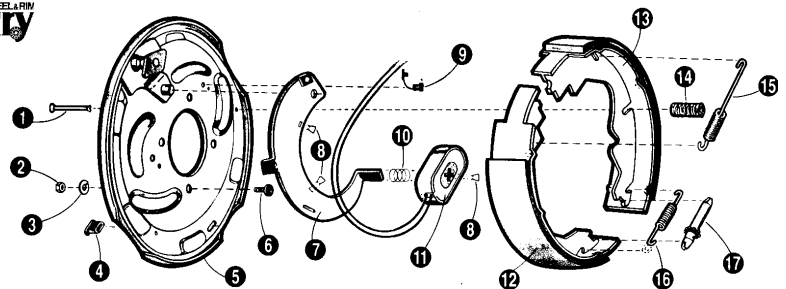

10" x 2-1/4" ELECTRIC BRAKE ASSEMBLY			
BRAKE PART DESCRIPTION	NO.	PART NO.	PRICE
RH Brake Assembly Complete	0	4701R	\$58.78
LH Brake Assembly Complete	0	4701L	58.78
Shoe Hold Down Pin	1	568094	P.O.R.
Brake Mounting Nut 7/16"-20	2	363312	P.O.R.
Brake Lockwasher 7/16"	3	363335	P.O.R.
Plug Adjuster Slot	4	568089	P.O.R.
Backing Plate Assembly	5	----	P.O.R.
Brake Mounting Stud 7/16"-20	6	363900	P.O.R.
RH Lever Assembly	7	568121	P.O.R.
LH Lever Assembly (Shown)	7	568122	P.O.R.
Clip, Wire & Magnet	8	568092	P.O.R.
Strain Relief, Wire	9	568090	P.O.R.
Magnet Spring	10	568103	P.O.R.
Magnet Assembly (Green Wire)	11	568119	P.O.R.
Primary Shoe & Lining	12	568112	P.O.R.
Secondary Shoe & Lining	13	568117	P.O.R.
Shoe Hold Down Spring	14	568093	P.O.R.
Shoe Retractor Spring	15	568097	P.O.R.
Adjuster Screw Spring	16	568095	P.O.R.
Adjuster Screw Assembly	17	568110	P.O.R.
Adjuster Screw Socket	17	568086	P.O.R.

12" X 2" ELECTRIC BRAKE ASSEMBLY			
BRAKE PART DESCRIPTION	NO.	PART NO.	PRICE
RH Brake Assembly Complete	0	4704R	\$76.46
LH Brake Assembly Complete	0	4704L	76.46
Brake Mounting Stud 3/8"-24	1	363989	P.O.R.
Shoe Hold Down Pin	2	568094	P.O.R.
Plug Adjuster Slot	3	568089	P.O.R.
Backing Plate Assembly	4	----	P.O.R.
Brake Lockwasher 3/8"	5	363334	P.O.R.
Brake Mounting Nut 3/8"-24	6	363333	P.O.R.
RH Lever Assembly	7	568113	P.O.R.
LH Lever Assembly (Shown)	7	568114	P.O.R.
Clip, Wire & Magnet	8	568092	P.O.R.
Strain Relief, Wire	9	568090	P.O.R.
Magnet Spring	10	568103	P.O.R.
Magnet Assembly (White Wire)	11	568111	P.O.R.
Primary Shoe & Lining	12	568126	P.O.R.
Secondary Shoe & Lining	13	568127	P.O.R.
Shoe Hold Down Spring	14	568093	P.O.R.
Shoe Retractor Spring	15	568096	P.O.R.
Adjuster Screw Assembly	16	568110	P.O.R.
Adjuster Screw Socket	16	568086	P.O.R.
Adjuster Screw Spring	17	568095	P.O.R.

Gray boxes are non-stocked items, short delivery time.