

### Beam Clamp

3/8-16" Rod Size  
2" Max Pipe  
400 lbs. Max Load



**BP38**  
**\$4.86**

### Four-Wheel Trolley

9/16" Holes  
3-1/2" Length  
3-1/4" Height  
600 lbs. Max Load

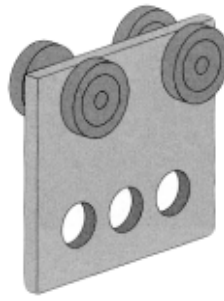

**PS-2522**  
**\$53.90**

### Three-Hole Splice Plate

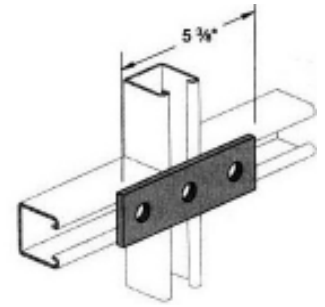

**PS-602**  
**\$3.66**

### Two-Hole End Angle

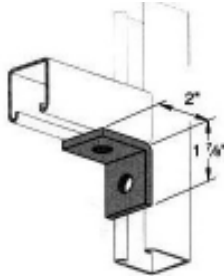

**PS-603**  
**\$2.64**

### Two-Hole Corner Angle

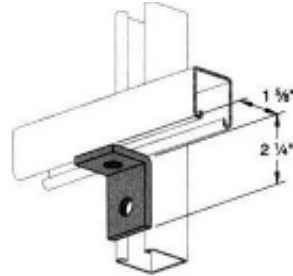

**PS-604**  
**\$2.40**

### Three-Hole Corner Angle

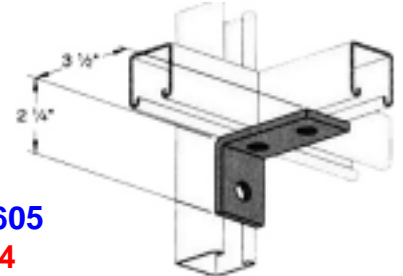

**PS-605**  
**\$3.84**

### Three-Hole Corner Angle

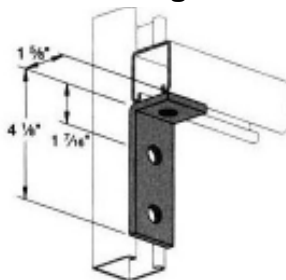

**PS-606**  
**\$3.30**

### Four-Hole Corner Angle

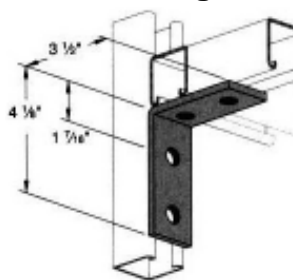

**PS-607**  
**\$4.42**

### Zee Support

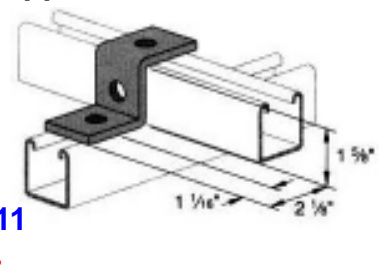

**PS-611**  
**\$4.54**

### "U" Support

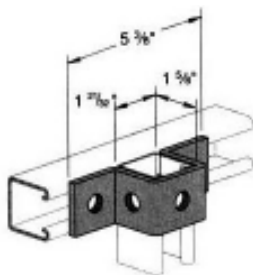

**PS-613**  
**\$5.50**

### Two-Hole Closed Angle 45°

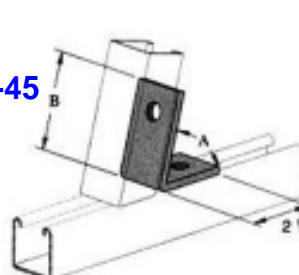

**PS-624-45**  
**\$6.78**

### Two-Hole Open Angle 45°

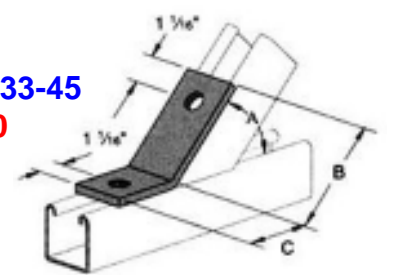

**PS-633-45**  
**\$5.30**

### Tee Plate

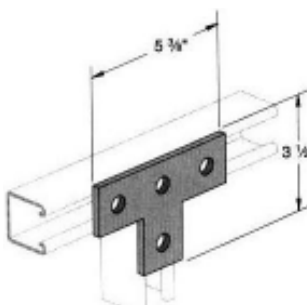

**PS-714**  
**\$10.20**

### Three-Hole Flat Angle Plate

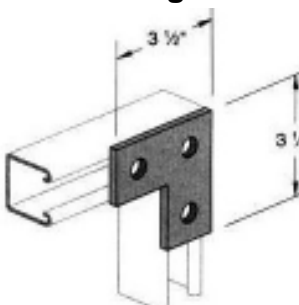

**PS-718**  
**\$6.86**

### Four-Hole Flat Angle Plate

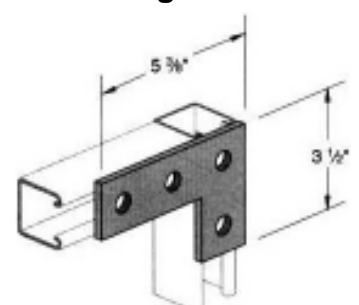

**PS-719**  
**\$12.80**